

KEY

ACCESSIBLE
CIRCULATION SPACES

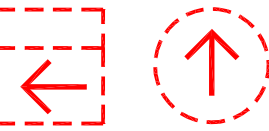

EGRESS PATH

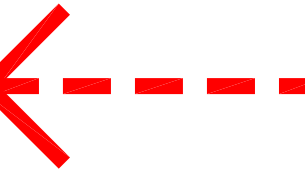

ACCESSIBLE CAR
SPACE

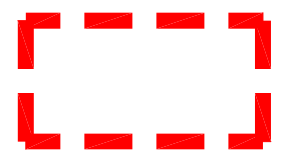

PROPOSED
ALTERATIONS

NEW ADDITION

DA1	REVISED FOR DA	21.07.2020
DA	FOR DA	04.12.2019
ISSUE	AMENDMENTS	DATE

NOTE:

- CHECK ALL THE DIMENSIONS ON SITE PRIOR TO COMMENCEMENT OF WORK.
- USE FIGURED DIMENSIONS ONLY, DO NOT SCALE.
- ALL WORK TO COMPLY WITH BCA, RELEVANT AUTHORITIES AND LOCAL COUNCIL.
- ALL GLAZING IN ACCORDANCE WITH AS 1288.
- ALL DISCREPANCIES TO BE REFERRED TO THE ARCHITECT PRIOR TO CONSTRUCTION.
- REFER TO STRUCTURAL ENGINEERS DETAIL FOR ALL STRUCTURAL INFORMATION.
- ELECTRICAL AND LIGHTING - NEW ELECTRICAL AND LIGHTING TO AUTHORITY & CODE REQUIREMENTS AND BCA.
- ALL TIMBER WORK IN ACCORDANCE WITH TIMBER FRAMING CODE.
- NEW STORM WATER TO BE CONNECTED TO EXISTING STORM WATER SYSTEM.
- NEW WASTE DRAINAGE TO BE CONNECTED TO EXISTING WASTE DRAINAGE SYSTEM.
- NEW TACTILE INDICATORS TO STAIRS & RAMPS TO AUSTRALIAN STANDARD AS 1428.4.
- ALL WORK IN ACCORDANCE WITH DISABLED CODE, AS 1428.1

Client:



Architect:

Axilarchitects
Architecture | Interior Design | Planning

Suit 27 2 Beattie St
Balmain
Sydney 2041 NSW
t: +61 (2) 9555 1100
f: +61 (2) 9555 4559
e: info@axil.com.au
w: www.axil.com.au
ABN: 53 095 103 281

Project

**REFURBISHMENT TO EXISTING
WALLACIA GOLF CLUB**
13 PARK RD, WALLACIA NSW 2745
LOT 1 / DP 1254545
LOT 3&4 / DP 18701

Title:

**PROPOSED GROUND FLOOR PLAN
ACCESSIBILITY & MOBILITY**

Scale:

1:200 @ A1

Drawn:	M.K.	Checked By:	D.H.	Date:	DEC 2019
Job Number:	259/19	Drawing Number:	AM.01	Issue:	DA1

ALL DRAWINGS REMAINS THE PROPERTY OF AXIL ARCHITECTS PTY LTD.
COPYRIGHT MAY 2019

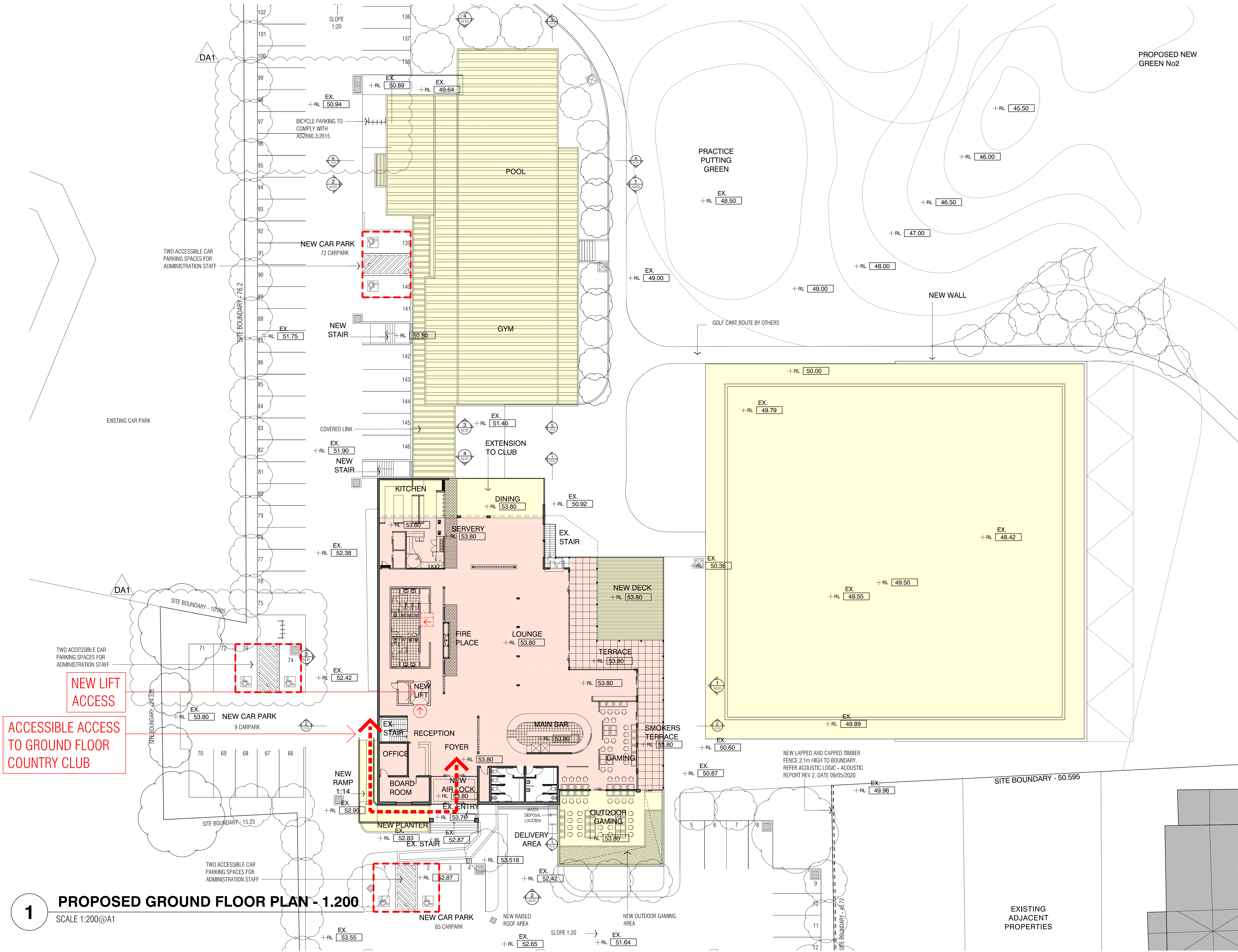

1 PROPOSED GROUND FLOOR PLAN - 1.200
SCALE 1:200@A1

FOR DEVELOPMENT APPLICATION

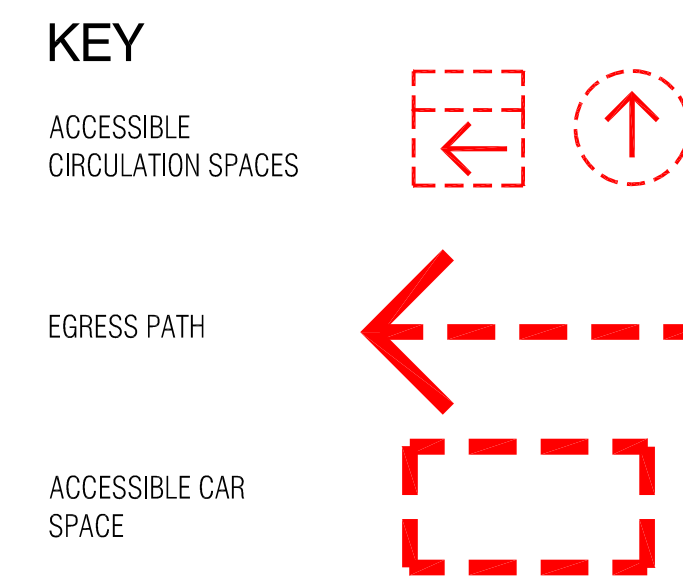

 **PROPOSED ALTERATIONS**

 **NEW ADDITION**

DA1	REVISED FOR DA	21.07.2021
DA	FOR DA	04.12.2021
ISSUE	AMENDMENTS	DATE

NOTE

1. CHECK ALL THE DIMENSIONS ON SITE PRIOR TO COMMENCEMENT OF WORK.
2. USE FIGURED DIMENSIONS ONLY. DO NOT SCALE.
3. ALL WORK TO COMPLY WITH BCA, RELEVANT AUTHORITIES AND LOCAL COUNCIL.
4. ALL GLAZING IN ACCORDANCE WITH AS 1288.
5. ALL DISCREPANCIES TO BE REFERRED TO THE ARCHITECT PRIOR TO CONSTRUCTION.
6. REFER TO STRUCTURAL ENGINEER'S DETAIL FOR ALL STRUCTURAL INFORMATION.
7. ELECTRICAL AND LIGHTING - NEW ELECTRICAL AND LIGHTING TO AUTHORITY & CODE REQUIREMENTS AND BCA.
8. ALL TIMBER WORK IN ACCORDANCE WITH TIMBER FRAMING CODE.
9. NEW STORM WATER TO BE CONNECTED TO EXISTING STORM WATER SYSTEM.
10. NEW WASTE DRAINAGE TO BE CONNECTED TO EXISTING WASTE DRAINAGE SYSTEM.
11. NEW FLOOR INDICATORS TO STAIRS & RAMPS TO AUSTRALIAN STANDARD AS 1428.4.
12. ALL WORK IN ACCORDANCE WITH DISABLED CODE, AS 1428.1

Client

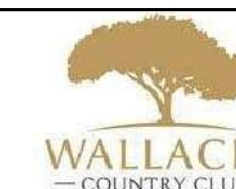

Architect

Axilarchitects
Architecture | Interior Design | Planning

Suit 27 2 Beattie St
Balmain
Sydney 2041 NSW
t: +61 (2) 9555 1100
f: +61 (2) 9555 4559
e: info@axil.com.au
w: www.axil.com.au
ABN: 53 095 103 281

Project

**REFURBISHMENT TO EXISTING
WALLACIA GOLF CLUB**

13 PARK RD, WALLACIA NSW 2745

LOT 1 / DP 1254545

LOT 3&4 / DP 18701

Title: **PROPOSED LOWER LEVEL PLAN
ACCESSIBILITY & MOBILITY**

Scale:
1:200 @ A1

Drawn: M.K.	Checked By: D.H.	Date: DEC 2019
Job Number: 259/19	Drawing Number: AM.02	Issue: DA1

ALL DRAWINGS REMAINS THE PROPERTY OF AXL ARCHITECTS PTY LTD
COPYRIGHT MAY 2019

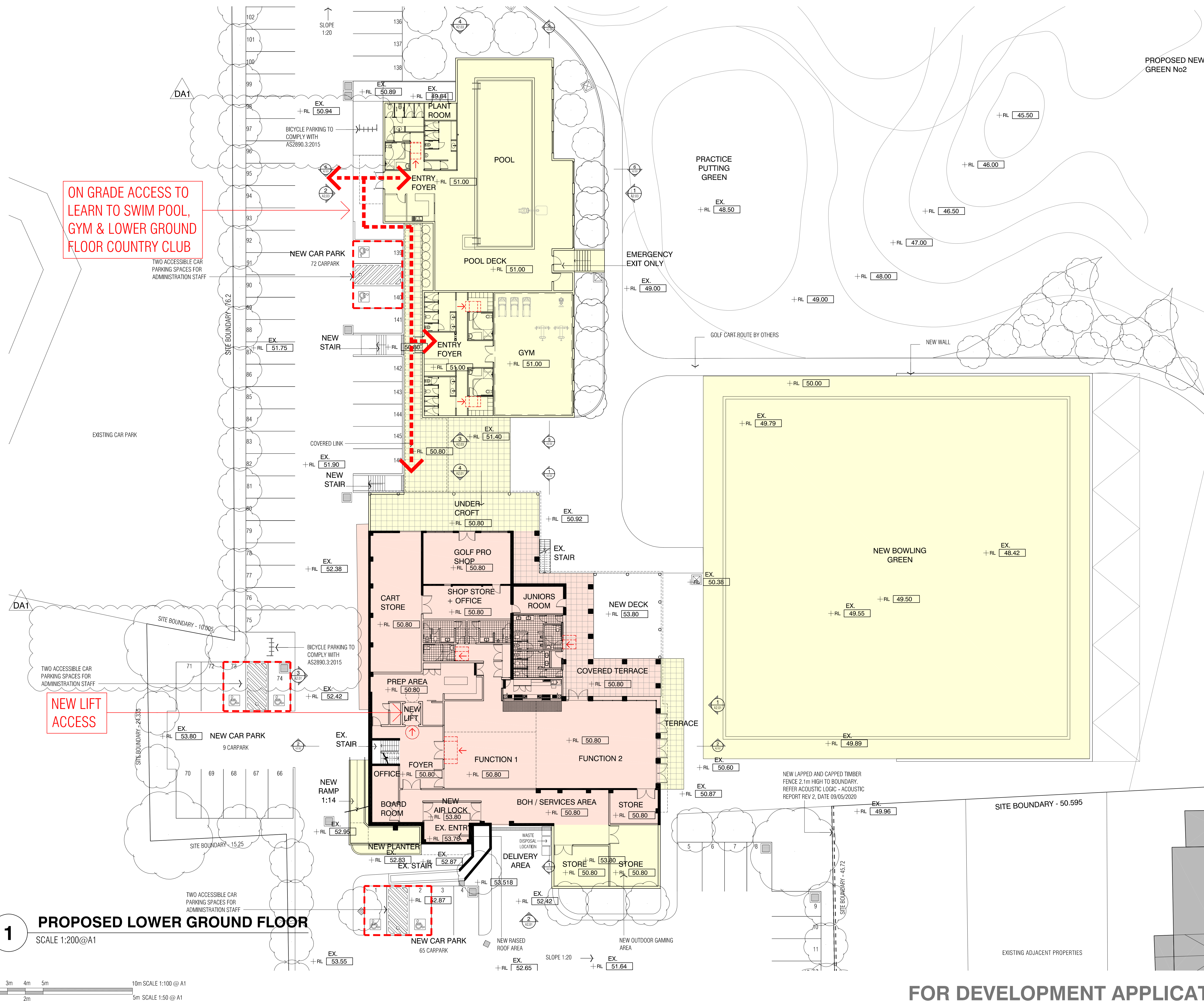

FOR DEVELOPMENT APPLICATION